

Land For Sale

- 36409 37thStreet, Palmdale, California, 93550

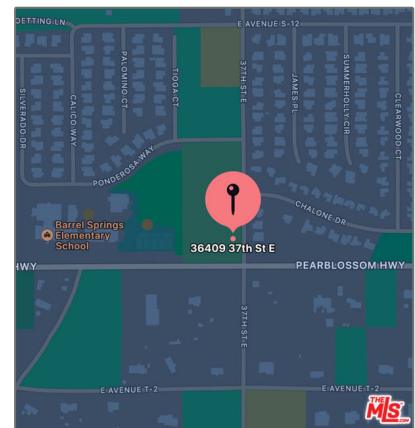
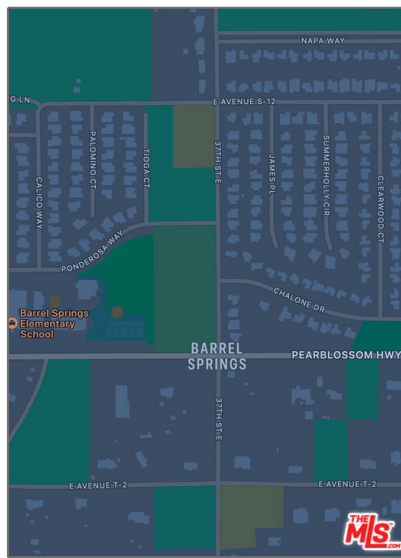
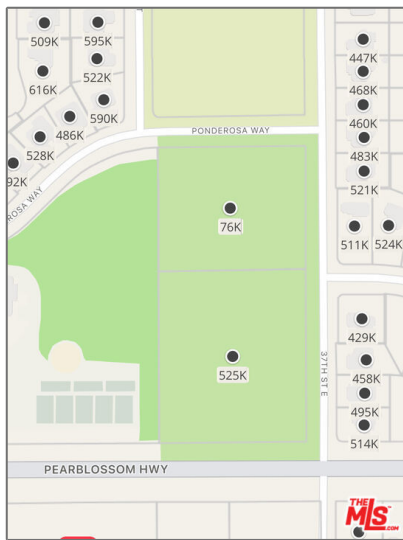

Basic Details

Status: **Active**

Listing Type: **For Sale**

Property Type: **Land**

Property SubType: **Single Family Residence**

Price: **\$1,200,000**

Price Per Square Foot: **\$7**

Lot Area: **4.10 Sqft**

View: **Mountain(s)**

Bathrooms: **5**

Country: **US**

State: **California**

County: **Los Angeles**

City: **Palmdale**

Zipcode: **93550**

Listing ID: **24460769**

Features

Association: **0**

Senior Community: **0**

Common Walls: **No Common Walls**

Stories: **2**

AttachedGarage: **1**

Parking: **Driveway, Garage - Two Door, Concrete**

Spa: **0**

Inclusions

Entry Level: **1**

Laundry: **Inside, Upper Level**

Flooring: **Tile**

Window Features: **Double Pane Windows**

Entry Location: **Upstairs**

Foundation Details: **Slab**

✓ Interior Features:	High Ceilings, Open Floorplan, Recessed Lighting
✓ Appliances:	Dishwasher, Disposal, Microwave, Refrigerator, Barbecue, Range Hood, Vented Exhaust Fan, Range
✓ Accessibility Features:	Doors - Swing In, Parking, 32 Inch Or More Wide Doors

MLS Addon

Zoning: **PDR1-7000**

Parcel Number: **3052014024**

Lot Size Square Feet: **178,596 Sqft**

TaxAnnualAmount: **\$0**

TaxYear: **0**

✓ RoomKitchenFeatures: **Kitchen Island, Kitchen Open To Family Room, Walk-in Pantry**

✓ RoomBathroomFeatures: **Shower In Tub, Vanity Area, Tile Counters**

High School: **Arlington**

High School 2: **Arling**

Middle Or Junior School: **Miller**

High School District: **Culver City Unified**

Levels: **Two**

✓ EatingArea: **Dining Room, In Kitchen**

Taxes: **\$0**

Guest House SqFt: **0 Sqft**

Approx Lot SqFt: **0 Sqft**

✓ Special Listing Conditions: **Standard**

Agent [Info](#)



Rina Maya
☎ 858-876-7946
☎ 800-878-0907
✉ Questions@unitedbrokersinc.net
