

Residential For Sale

1,596 Sqft - 21403 Dana Point Lane, Cupertino, California, 95014

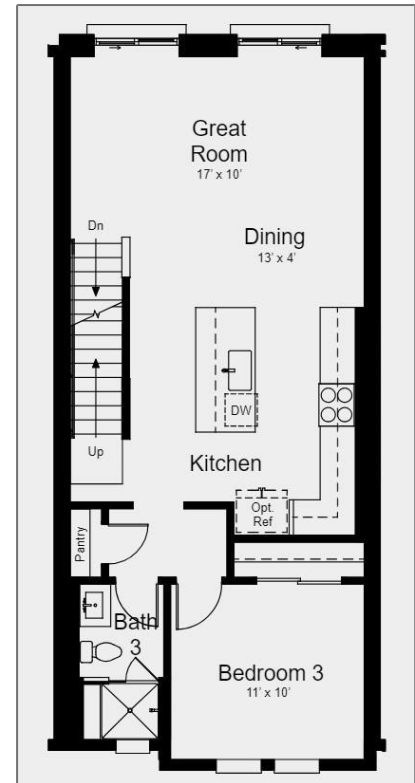
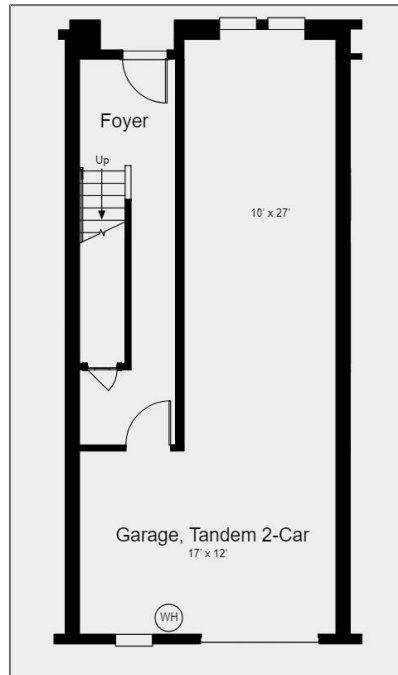

Basic Details

Status:	Active
Listing Type:	For Sale
Property Type:	Residential
Property SubType:	Condominium
Price:	\$1,964,000
Price Per Square Foot:	\$1,231
Square Footage:	1,596 Sqft
Year Built:	2024
View:	Mountain(s)
Bedrooms:	3
Bathrooms:	3
Bathrooms	3

Features

Association:	1
Stories:	3
✓ Amenities:	Management, Trash, Insurance
AttachedGarage:	1
✓ Parking:	2.00
✓ Parking:	Guest
✓ Room Type:	Walk-in Closet
✓ Roofing:	Tile
✓ Flooring:	Carpet, Tile, Laminate
✓ Foundation Details:	Slab
✓ Heating System:	

(Full):	
Country:	US
State:	California
County:	Santa Clara
City:	Cupertino
Zipcode:	95014
Listing ID:	ML81986574

<input checked="" type="checkbox"/>	Cooling System:	Central
<input checked="" type="checkbox"/>	Water Source:	Central Air
<input checked="" type="checkbox"/>	Sewer:	Public
<input checked="" type="checkbox"/>	Appliances:	Public Sewer
		Dishwasher, Electric Oven, Microwave, Range Hood, Electric Cooktop

MLS [Addon](#)

Association Fee Frequency:	Monthly
Zoning:	CG
Parcel Number:	32662057
TaxAnnualAmount:	\$0
Association Fee:	\$440
<input checked="" type="checkbox"/> RoomKitchenFeatures:	Quartz Counters
Garage Spaces:	2
High School:	Arlington
High School 2:	Arling
Middle Or Junior School:	Miller
High School District:	Other
Taxes:	\$0
Guest House SqFt:	0 Sqft
Approx Lot SqFt:	0 Sqft

Agent [Info](#)



Rina Maya

☎ 858-876-7946

☎ 800-878-0907

✉ Questions@unitedbrokersinc.net
