

- 0 El Dorado Avenue, Mojave, California, 93501

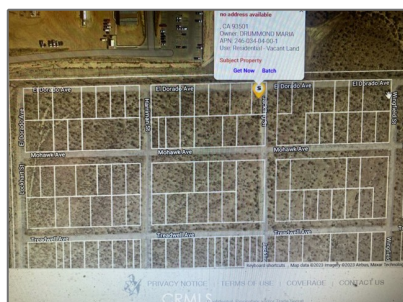

Status:	Active
Listing Type:	For Sale
Property Type:	Land
Property SubType:	Single Family Residence
Price:	\$5,999
Price Per Square Foot:	\$1
Lot Area:	0.13 Sqft
View:	Mountain(s)
Bathrooms:	3
Country:	US
State:	California
County:	Kern
City:	Mojave
Zipcode:	93501
Listing ID:	DW25034033

✓	View:	Desert
Association:		0
Senior Community:		0
✓	Common Walls:	No Common Walls
Stories:		1
✓	Community Features:	Hiking
AttachedGarage :		1
✓	Lot Features:	0-1 Unit/acre, Agricultural
Entry Level:		1
✓	Laundry:	Individual Room, Inside
✓	Flooring:	Stone, Bamboo
✓	Entry Location:	Livingroom
Main Level Bathrooms:		3
Main Level Bedrooms:		3

Zoning:	<b>A-1</b>
Parcel Number:	<b>24603404001</b>
Lot Size Square Feet:	<b>5,690 Sqft</b>
TaxAnnualAmount:	<b>\$0</b>
TaxYear:	<b>0</b>
High School:	<b>Arlington</b>
High School 2:	<b>Arling</b>
Middle Or Junior School:	<b>Miller</b>
High School District:	<b>Los Angeles Unified</b>
Levels:	<b>One</b>
Taxes:	<b>\$0</b>
Guest House SqFt:	<b>0 Sqft</b>
Approx Lot SqFt:	<b>0 Sqft</b>
<input checked="" type="checkbox"/> Special Listing Conditions:	<a href="#">Standard</a>

Agent [Info](#)

---



Rina Maya  
☎ 858-876-7946  
☎ 800-878-0907  
✉ [Questions@unitedbrokersinc.net](mailto:Questions@unitedbrokersinc.net)