

Land For Sale

- 109 Aztec Avenue, 29 Palms, California, 92277

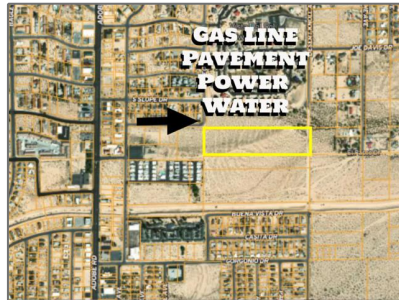
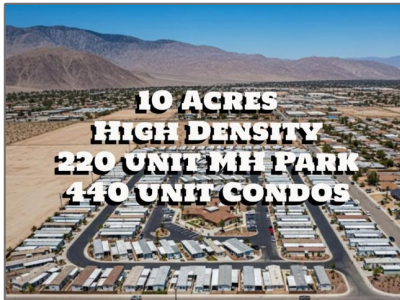

Basic Details

Status: **Active**

Listing Type: **For Sale**

Property Type: **Land**

Property SubType: **Single Family Residence**

Price: **\$480,000**

Price Per Square Foot: **\$1**

Lot Area: **10 Sqft**

View: **Mountain(s)**

Bathrooms: **2**

Country: **US**

State: **California**

County: **San Bernardino**

City: **29 Palms**

Zipcode: **92277**

Listing ID: **219133369PS**

Features

✓ View: **City Lights, Mountain(s), Panoramic, Hills, Desert, Valley**

Association: **1**

Senior Community: **0**

✓ Common Walls: **2+ Common Walls**

Stories: **2**

✓ Amenities: **Pool, Spa/hot Tub, Trash, Sewer**

Attached Garage: **0**

✓ Parking: **Tandem Covered**

Spa: **1**

✓ Lot Features: **Rectangular Lot, Horse Property, Corner Lot, Near Public Transit**

Entry Level: **1**

✓ Laundry: **Stackable, See Remarks, In Closet**

✓ Flooring: **Carpet, Laminate**

✓ Window Features: **Double Pane Windows**

✓ Entry Location

✓	Spa Construction:	Community, Association
✓	Property Condition:	Turnkey
✓	Interior Features:	High Ceilings, Open Floorplan, Two Story Ceilings, Cathedral Ceiling(s), Storage
Main Level Bathrooms:		
		2
Main Level Bedrooms:		
		2
✓	Utilities:	Electricity Available, Phone Available
✓	Sewer:	Other
✓	Appliances:	Built-in Range, Microwave

MLS Addon

Parcel Number:	0623131090000
Lot Size Square Feet:	435,600 Sqft
TaxAnnualAmount:	\$0
TaxYear:	0
High School:	Arlington
High School 2:	Arling
Middle Or Junior School:	Miller
High School District:	Los Angeles Unified
Levels:	Two
✓ EatingArea:	Area
Taxes:	\$0
Guest House SqFt:	0 Sqft
Approx Lot SqFt:	0 Sqft
✓ Special Listing	Standard

Conditions:

Agent [Info](#)



Rina Maya

☎ 858-876-7946

☎ 800-878-0907

✉ Questions@unitedbrokersinc.net
