

# Land For Sale

- 16890 El ReposoCircle, Joshua Tree, California,  
92252

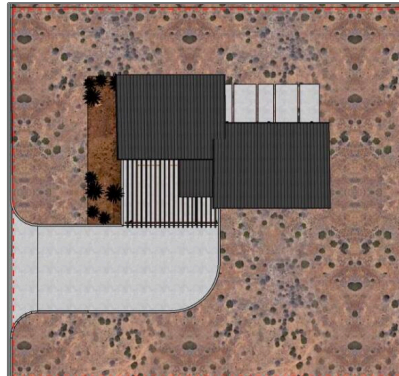

## Basic Details

Status: **Active**

Listing Type: **For Sale**

Property Type: **Land**

Property SubType: **Single Family Residence**

Price: **\$75,000**

Price Per Square Foot: **\$4**

Lot Area: **0.42 Sqft**

View: **Mountain(s)**

Bathrooms: **4**

Country: **US**

State: **California**

County: **San Bernardino**

City: **Joshua Tree**

Zipcode: **92252**

Listing ID: **219136144PS**

## Features

Association: **1**

Senior Community: **0**

✓ Common Walls: **No Common Walls**

Stories: **2**

AttachedGarage : **1**

✓ Lot Features: **Park Nearby, Corner Lot, Near Public Transit**

✓ Flooring: **Carpet, Tile, Laminate**

✓ Window Features: **Skylight(s)**

✓ Foundation Details: **Concrete Perimeter**

✓ Utilities: **Electricity Available, Phone Available, Propane, Underground Utilities, Other**

✓ Sewer: **Other**

✓ Appliances: **Dishwasher, Disposal, Microwave, Refrigerator, Gas Cooktop, Range Hood, Vented Exhaust Fan**

✓ Accessibility

MLS [Addon](#)

Parcel Number:	0603121220000
Lot Size Square Feet:	18,295 Sqft
TaxAnnualAmount:	\$0
TaxYear:	0
<input checked="" type="checkbox"/> RoomKitchenFeatures:	Kitchen Island
<input checked="" type="checkbox"/> RoomBathroomFeatures:	Granite Counters, Double Sinks In Bath(s), Jetted Tub
High School:	Westmont
High School 2:	Westmo
Middle Or Junior School:	Rolling Hills
Elementary School:	Capri
High School District:	Other
<input checked="" type="checkbox"/> EatingArea:	Breakfast Counter / Bar, Breakfast Nook, In Living Room
Taxes:	\$0
Guest House SqFt:	0 Sqft
Approx Lot SqFt:	0 Sqft
<input checked="" type="checkbox"/> Special Listing Conditions:	Standard

Agent [Info](#)

---



Rina Maya

☎ 858-876-7946

☎ 800-878-0907

✉ [Questions@unitedbrokersinc.net](mailto:Questions@unitedbrokersinc.net)

---