

Residential For Sale

3,938 Sqft - 31630 Sea Level Drive, Malibu,
California, 90265

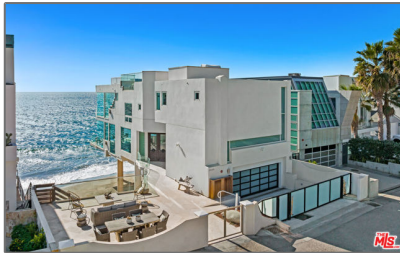

Basic Details

Status: **Active**

Listing Type: **For Sale**

Property Type: **Residential**

Property SubType: **Single Family Residence**

Price: **\$11,750,000**

Price Per Square Foot: **\$2,984**

Square Footage: **3,938 Sqft**

Lot Area: **0.11 Sqft**

Year Built: **1994**

View: **Mountain(s)**

Bedrooms: **4**

Bathrooms: **6**

Bathrooms (Full): **5**

Bathrooms (1/2): **1**

Country: **US**

State: **California**

County: **Los Angeles**

City: **Malibu**

Zipcode: **90265**

Features

✓ View: **City Lights, Mountain(s), Ocean, Panoramic, Coastline, Catalina, Water, White Water**

Association: **1**

Senior Community: **0**

✓ Common Walls: **No Common Walls**

Stories: **4**

✓ Parking: **4.00**

✓ Parking: **Driveway, Garage - Two Door, Guest, Uncovered, Covered, Parking Space, Private, Street, Unassigned**

Spa: **1**

✓ Fireplace: **Living room, Master bedroom, Bath**

✓ Lot Features: **Front Yard**

✓ Fence: **Glass**

✓ Security: **Gated community, 24 hour security, Fire Sprinkler System**

✓ Patio: **Deck, Covered, Roof Top, Patio Open**

✓

Water front Features:

Ocean Front

Listing ID:23307351

✓	Laundry:	Inside, In Garage
✓	Room Type:	Living Room, Walk-in Closet, Master Bathroom, Walk-in Pantry
✓	Roofing:	Composition
✓	Flooring:	Wood, Carpet
✓	Window Features:	Double Pane Windows
✓	Entry Location:	Front Door/level 1
✓	Spa Construction:	Heated, Above Ground, Private
✓	Property Condition:	Updated/remodeled
✓	Foundation Details:	Raised
✓	Interior Features:	High Ceilings, Open Floorplan, Recessed Lighting, Wet Bar, Living Room Deck Attached, Elevator
✓	Heating System:	Central
✓	Cooling System:	Central Air
✓	Water Source:	Public
✓	Sewer:	Septic Type Unknown
✓	Appliances:	Dishwasher, Disposal, Double Oven, Refrigerator, Range, Built-in

MLS Addon

Association Fee Frequency:	Quarterly
Zoning:	LCR1*
Parcel Number:	4470001004
Lot Size Square Feet:	4,713
TaxAnnualAmount:	\$0

Association Fee:	\$1,588	
✓ RoomKitchenFeatures:	Kitchen Island, Stone Counters	
✓ RoomBathroomFeatures:	Shower, Shower In Tub, Jetted Tub, Vanity Area	
High School:	Arlington	
High School 2:	Arling	
Middle Or Junior School:	Miller	
High School District:	Santa Monica-Malibu Unified	
Levels:	Three Or More	
✓ EatingArea:	Dining Room, In Kitchen, Breakfast Counter / Bar, In Living Room	
Taxes:	\$0	
Guest House SqFt:	0	
Approx Lot SqFt:	0	
✓ Special Listing Conditions:	Standard	

Agent [Info](#)



Rina Maya

 858-876-7946

 800-878-0907

 Questions@unitedbrokersinc.net